



Pit Bull Safety Cover® Installation Manual

Channel System (MEDIUM to HEAVY DUTY)

Professional Netting Concepts LLC ©1994, 2001, 2009, 2017, 2021, 2022

Scan QR code on next page to watch installation instructions

Pit Bull Safety Cover® Channel System

Congratulations on your purchase of the Pit Bull Safety Cover®. Your cover is designed and constructed to “reduce” or minimize injuries sustained in the course of normal use when installed correctly is not only reliable but convenient to those who use it. Your Pit Bull is removable and very easy to clean. The polyester fiber does not absorb water, grease or oil. Pit Bull is knot-free and exceeds OSHA/CFR safety standards.

If you have any questions or comments, feel free to contact one of our representatives at 832-515-8385.

WARNING

An improperly installed Pit Bull Safety Cover® can become unstable and/or malfunction causing serious injury.

READ THESE INSTRUCTIONS CAREFULLY! FAILURE TO FOLLOW THESE INSTRUCTIONS CAN DAMAGE THE PRODUCT OR CAUSE THE PRODUCT TO NOT PERFORM CORRECTLY.

Before you begin:

1. Please read this manual in its entirety before you begin the installation process.
2. Follow all instructions thoroughly.
3. EXTREMELY IMPORTANT! Prepare the work area, be sure that all flammable products have been removed from the service bay and that any paint, grease or debris has been removed from the area before any welding begins.
4. Use only a certified welding technician that is knowledgeable in safety compliance and is aware of the area and all safety precautions that need to be engaged.
5. Please follow all General Welding Practices.

Scan QR Code for Channel System video installation instructions



Materials Provided:

- Pit Bull Safety Cover®
- No-Step Label
- Magnetic pins & backings
- Detent pins
- Sliding channel and rods
- Adaptors (10" Bolt/6" Hook)
- (4) 1.5" Stainless bolts
- (24) Flange Head Nuts
- (24) Flange Head Bolts

Other Materials Needed:

- All necessary PPE
- Pry bar
- Drill
- Propane torch
- Tape measure
- Grease or sprayed graphite
- Saw
- Bolt cutters
- Long screwdriver
- Crescent wrench

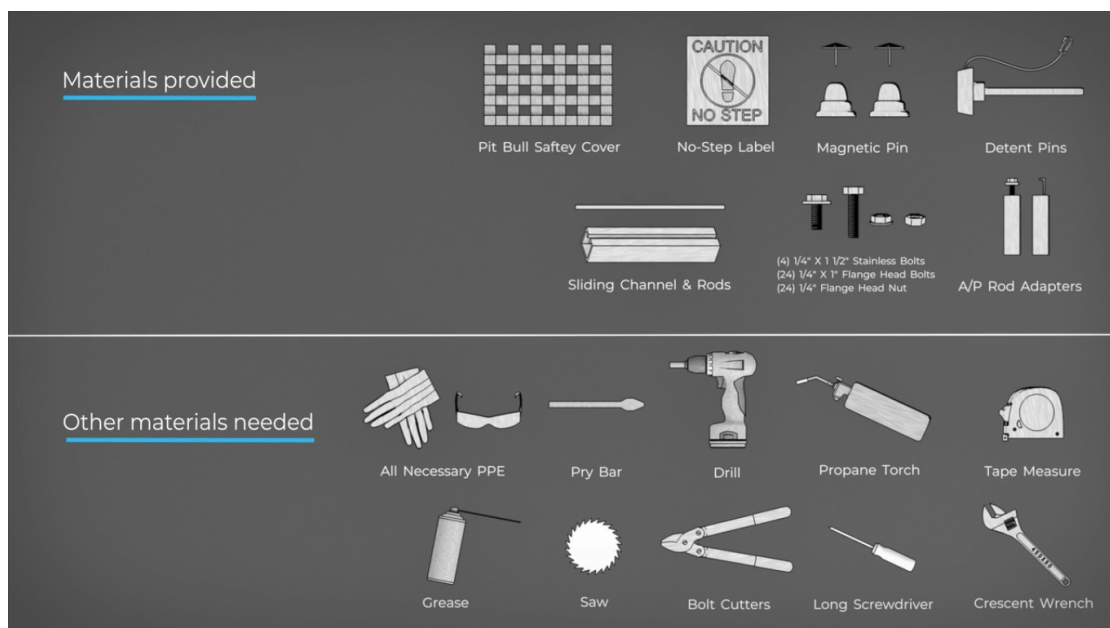

Step #1: Remove existing pit cover and existing pit cover and existing pit cover tracks if necessary.

(Optional with Diamond Plate Application)

Step #2: FOR USE WITH LOCKING MECHANISM ONLY! Consider the proper location for the locking mechanism.

Measure the inside clearance of the tire guides. The tire guides must be parallel with $\pm \frac{1}{4}$ ". Use the narrowest width throughout the pit. See example below.

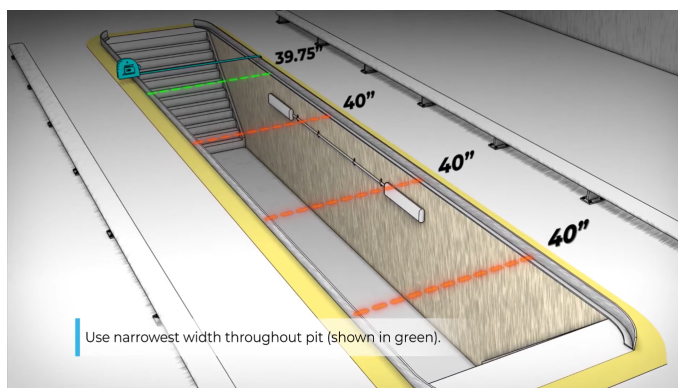

If clearance difference is greater than $\pm \frac{1}{4}$ ", shim between tire guides and sliding channel to maintain clearance tolerance. Weld shims to tire guides and sliding channel.

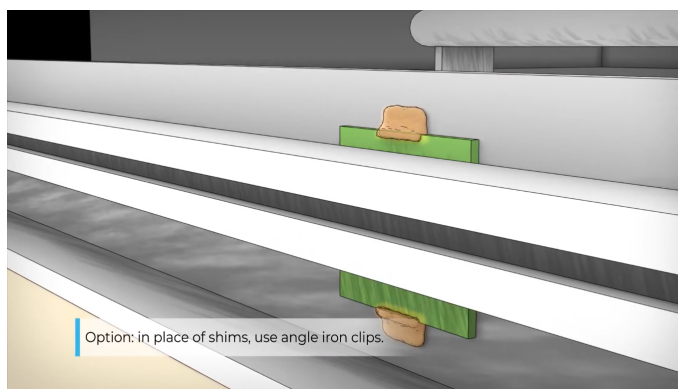

Step #3: Welds to be 1" long and 12" on center on both top and bottom, of railing with welds in an alternate position. **CAUTION! Do not WELD the face of the channel.**

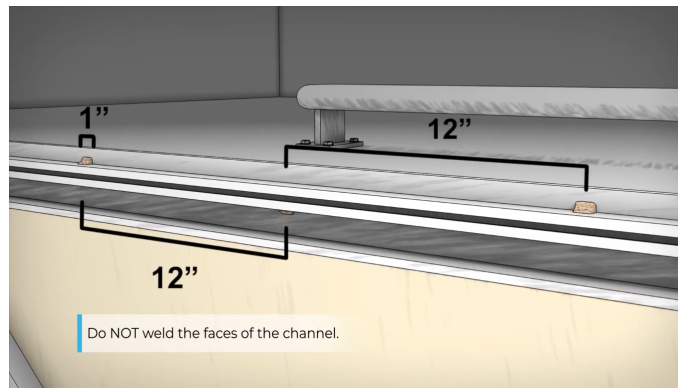

After welding, Use a Hardened Pry Bar to spread the face of the channel open slightly. **CAUTION! Do not use heavy force to open.**

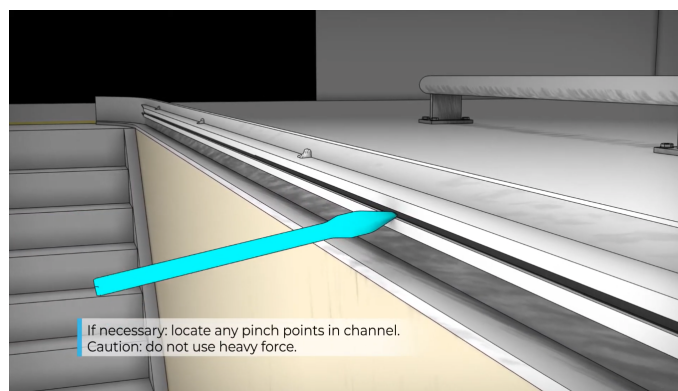

If you need to extend the length of the sliding channels, flare both sections coming together. Weld the top to secure in place.

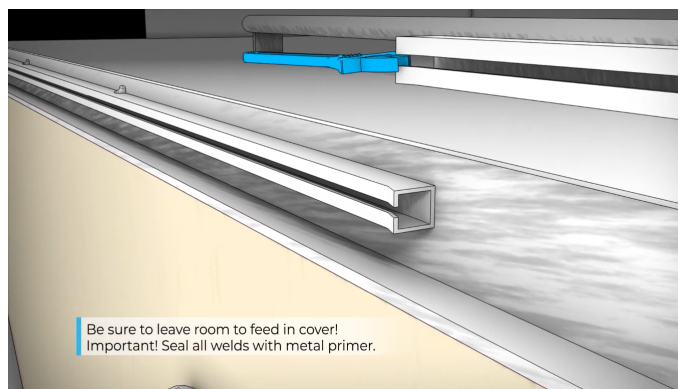

Weld the top to secure in place.

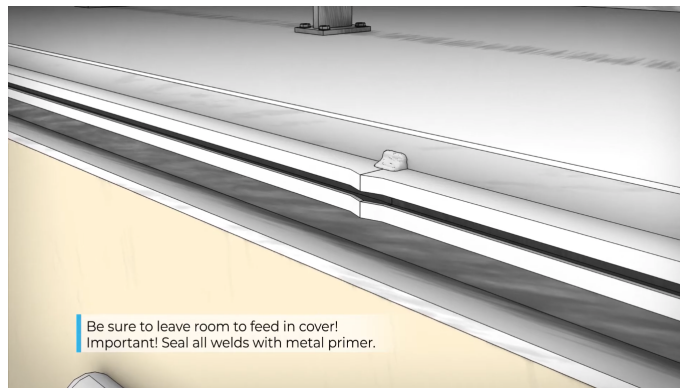

Step #4: Welding is not recommended*

Cut Active/Passive rods (A/P Rods) to correct length. (4" short of the width of the track to track measurement).

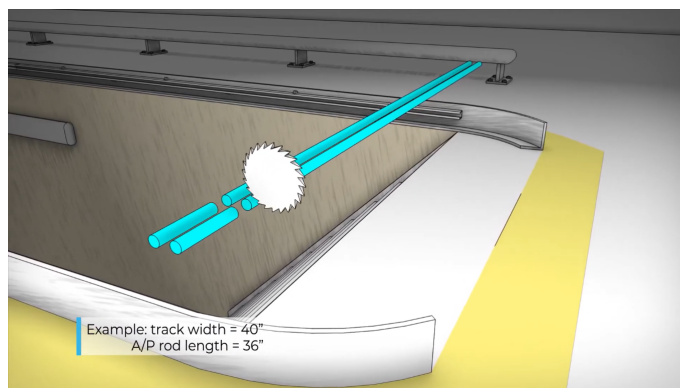

Insert the adaptors onto the ends of the A/P rods.

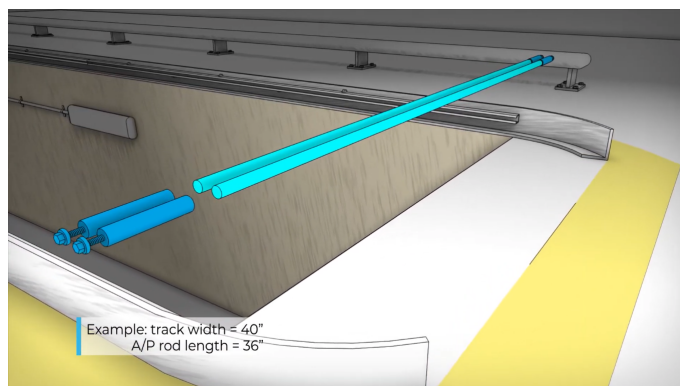

Slide the A/P rods into the tracks using the adaptor (10"bolt/6" hook)

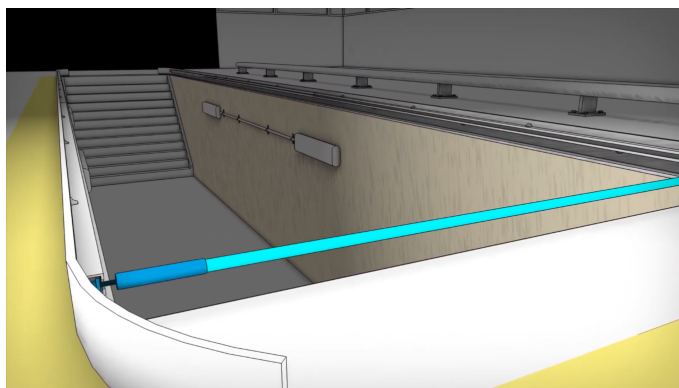

Step 5: Adjust the tension of your safety cover using the drill and bolt adjuster on each T-Bolt.

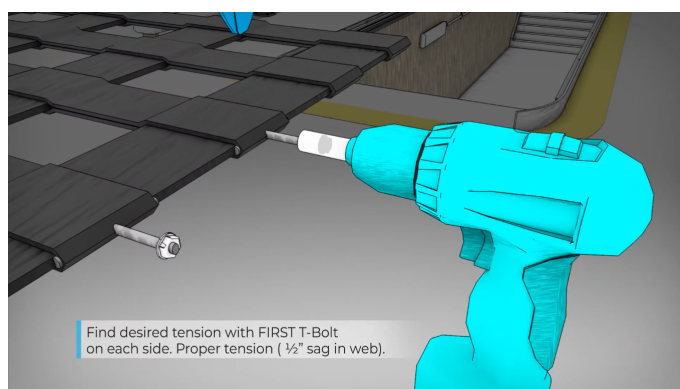

Drilling them down to the correct depth and cutting off excess length as needed using bolt cutters.

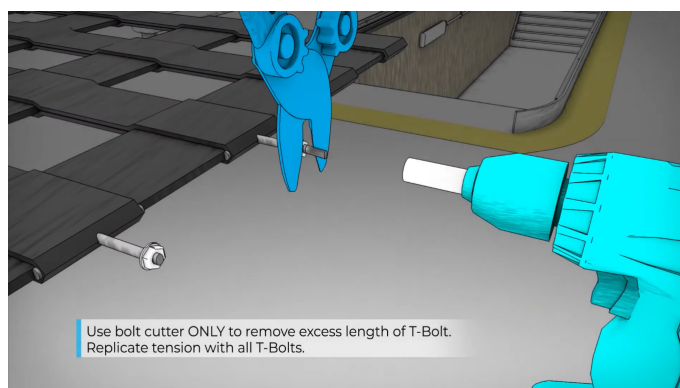

Then slide the bolts and cover into the track.

For help with installation or operation of this product, contact a PNC representative at (832) 515-8385

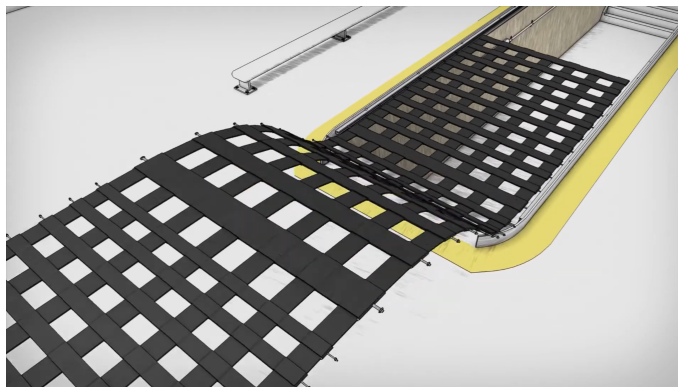

Drill (2) $\frac{1}{4}$ inch holes through the center channel on all corners at 1-inch and 2-inch mark from each end.

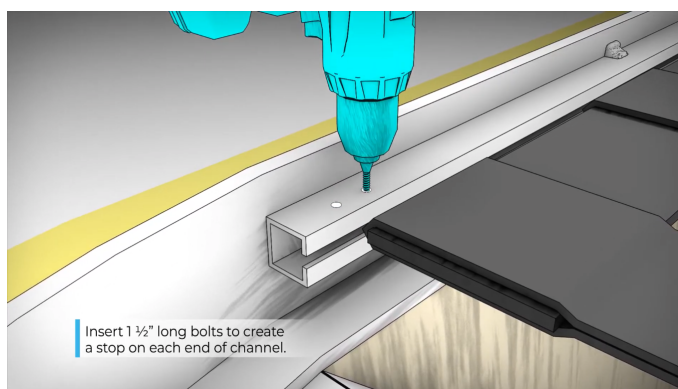

Insert long bolts into the 1 inch to put a stop to the passive end. Then insert detent pins into the 2-inch holes on all corners.

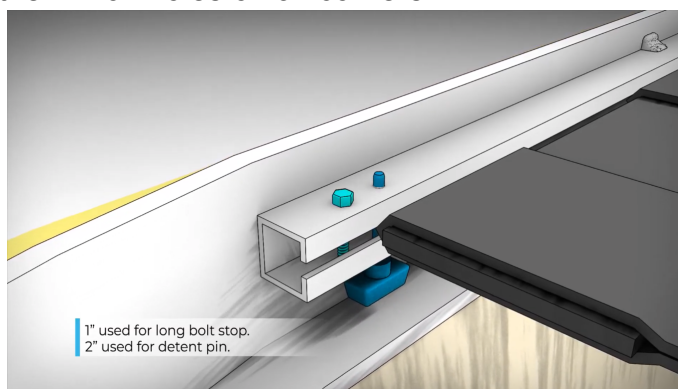

Using a propane torch heat the head of a screwdriver (or soldering iron) until red hot and poke holes through the crisscross fabric on the bottom 2 rows of your pit bull safety cover.

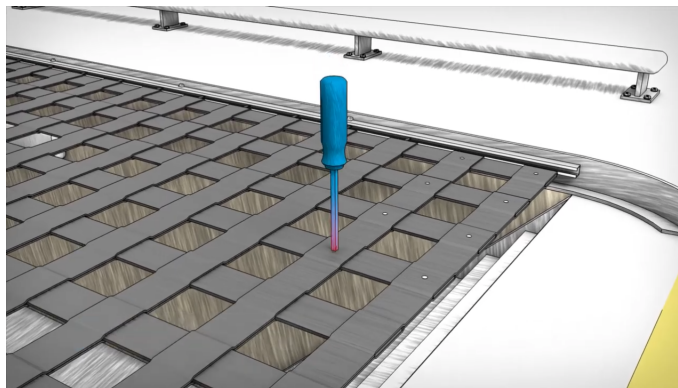

Fold the fabric ends over the rod creating a pocket and secure it with the screw and nut use washer to narrow holes if necessary

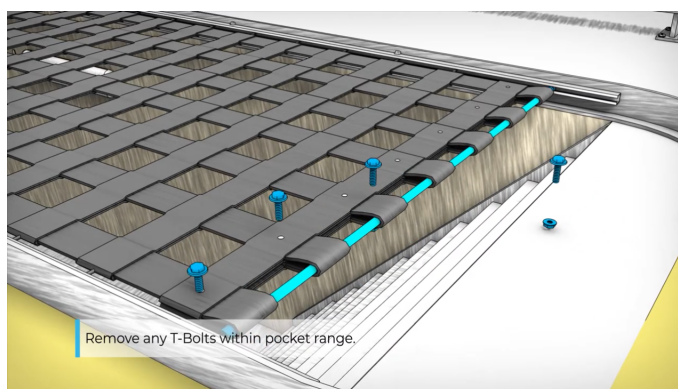
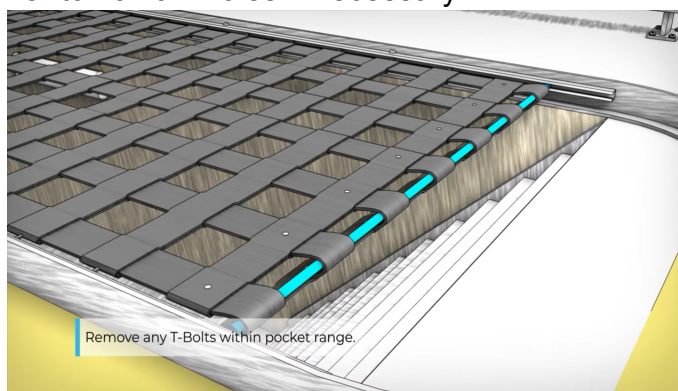

Use a blowtorch to burn off any excess fabric and seal the edges. Then tighten bolts to secure in place.

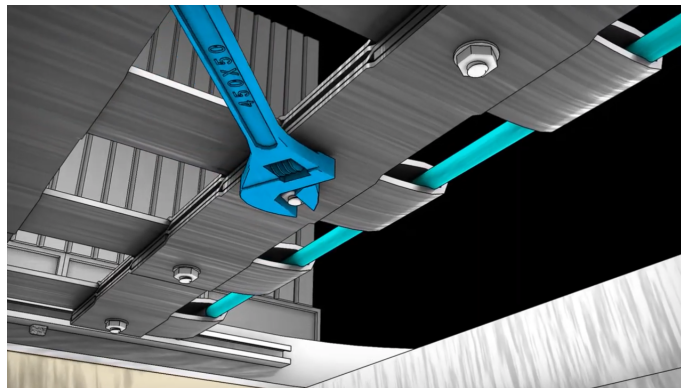
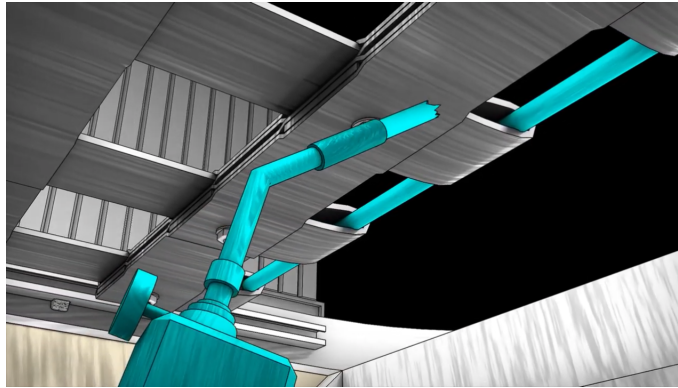

Remove detent pin and slide cover between the 1" and 2" drilled holes and re-insert the detent pin from the bottom and secure. Latch each lanyard to the closest t- Bolt. Repeat on the other side.

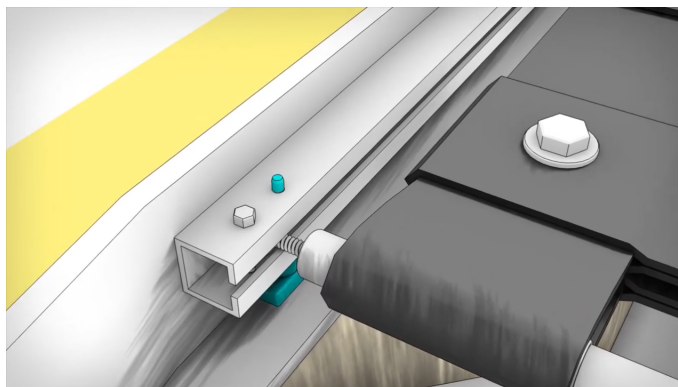

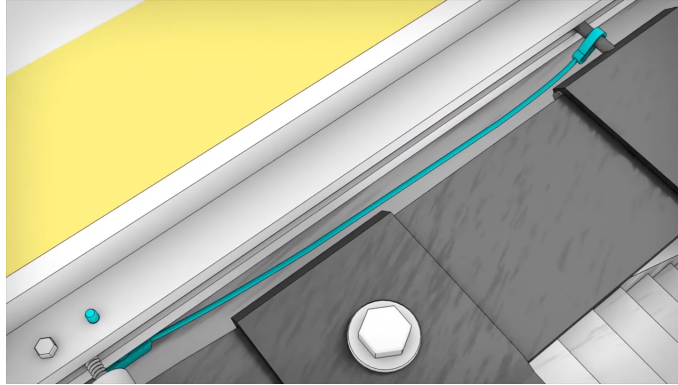

Spray grease or dry graphite into the track to ensure the bolts run smoothly

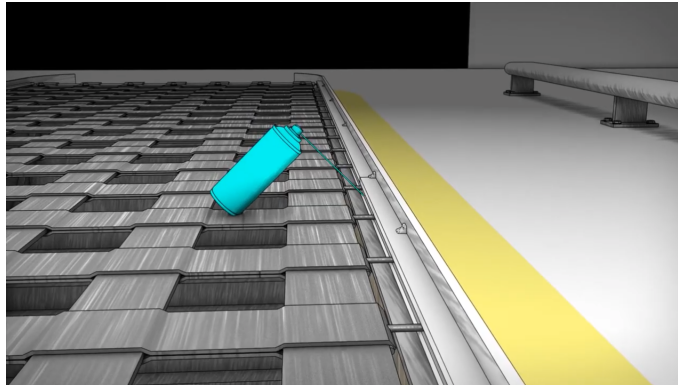

Finally place the no step sign 2'-3' from the foot of both ends using magnetic pins and backings to secure the cover. **WARNING! You cannot remove the label once it has been secured.**



Your Pit Bull Safety Cover® Channel system installation is now complete. If you have any questions about processes or materials, please call a representative today.

Care and Maintenance

It is not necessary to remove your Pit Bull to clean if you generally wash your pit area from top to bottom. However, in order to get the maximum life from your Pit Bull Safety Cover®, we recommend you follow the care and maintenance instructions below.

Professional Netting Concepts LLC. suggests you use a bleach free soap, such as DAWN Dishwashing Liquid or Woolite Laundry Detergent and hot water. Both these products are a mild detergent that will not harm your cover. With a medium stiff brush, apply soap and water over the Pit Bull and scrub. Rinse thoroughly.

Cornstarch or baby talc can be used to remove stubborn grease stains. Brush off loose dirt, cover the stain with cornstarch or baby talc, and leave on the grease spot overnight. Then brush off the cornstarch or baby talc. Most, if not all of the stain should disappear. However, if it is necessary repeat the process again.

For a DEEP CLEAN you can remove your Pit Bull Safety Cover from the channel and take it to your nearest car wash. Use the foaming brush or high power washer to clean your Pit Bull Safety Cover®. **You may use the same process to clean your No-Step labels.**

WARNING!!!

NEVER USE strong cleaners, petroleum based products or bleaches (this includes Oxi-clean) Avoid using harsh chemical or industrial strength cleaners. **DO NOT** use any cleaning agent that is a solvent based or solvent containing cleanser. These are typically called “degreasers”. The use of degreasers over time will fade or lessen the strength of the webbing material. **DO NOT** use any kind of hydrocarbon solvent, it was found to weaken the webbing considerably.



The information contained in this manual is the exclusive property of Professional Netting Concepts, L.L.C. and protected by copyright and other proprietary rights. Nothing contained in this manual may be reproduced, distributed or edited in any manner without the prior written authorization of Professional Netting Concepts, L.L.C. No reproduction is permitted without specific written authorization. You may not distribute, modify, transmit, reuse, report, or use the contents of this information for public or commercial purposes, including text, images, prices or other information without Professional Netting Concepts, L.L.C. written permission.

One-Year Limited Warranty

PARTS – New parts in exchange for the defective parts for one (1) year after original purchase (excluding shipping and handling charges). This warranty only covers failures due to defects in material or hardware which occur during normal use. It does not cover failures due to damage in shipment, or failures which are caused by products not supplied by Professional Netting Concepts, L.L.C. or failures which result from an accident, vehicular traffic, misuse, abuse, neglect, mishandling, misapplication, alteration, faulty installation (by others not directly employed by Professional Netting Concepts, L.L.C., and any modification. Warranty does not cover damage cause by fire, floods, hurricanes, cyclones, tornadoes, earthquakes or any other extraordinary or unusual event. In no event shall Professional Netting Concepts, L.L.C. be liable for any consequential damages or for damages to the building or its contents or injury to its occupants.

INSTALLATION – Professional Netting Concepts, L.L.C. will only repair manufacture installations and/or replace your cover free of charge in the U.S.A. in the event of a defect in workmanship or material. Installation warranties are only given on manufacture installations. Manufacture Installations include a one (1) year warranty from the date of installation. Any person, not directly employed by Professional Netting Concepts, L.L.C. performing installations of Pit Bull Safety Covers will not be covered by the warranty.

This warranty is extended only to the original purchaser. A proof of purchase will be required before warranty performance is rendered.

The warranty shall be void if Professional Netting Concepts, L.L.C. fails to receive full payment. This warranty gives you specific legal rights and you may also have rights which vary from state to state.

If a problem with your Pit Bull Safety Cover® develops during the warranty period, please contact a representative with Professional Netting Concepts, L.L.C.